

## 2-Wire Monitors and Door Stations Updates

Remarkable updates for 2-Wire products.

### Features Highlights

- ✚ Simply connect the system, switch it on and expect it to work.
- ✚ System becomes simply 'plug & play' with minimal input from the installer.
- ✚ A single person installing/configuring the system.
- ✚ System can be installed and commissioned by unskilled personnel, so it is important systems function 'out of the box' and have minimal set-up time.

### 1. Voice Promote

Door stations such as DT607S/DT611 all series /DT608/DT610 all series/DMR21 will have voice promote function, to offer voice promote for operation for door station. Such as:

**"Door is open"** when door is open.

**"System is busy"** when other door station is in talking.

**"Resident is unavailable"** when visitor calls to not exist monitor.

**"Call is in progress"** when door station is calling to monitor.

**"You can speak now"** when user accept visitor's calls.

### 2. Improved Fisheye Camera Performance

Greatly reduces video noise in dim light, better image in backlighting condition.

DT610/611: Improved structure to avoid interference light from night LED (veiling glare).

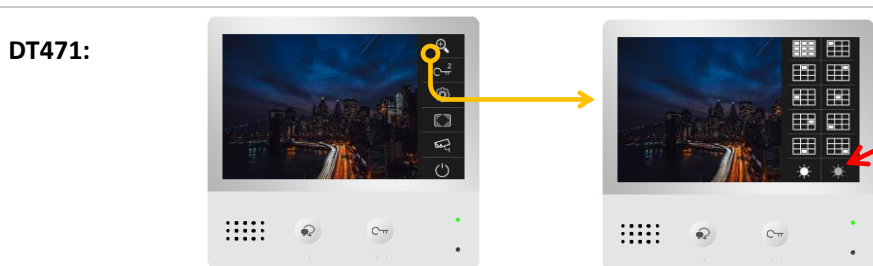

DT471:

*With video shows,  
tap "Zoom"*

*Tap "Lightness"*

DT437:



*With video shows,  
press "Menu"*

*Press "Menu" until  
"Lightness" show*

Allow user to setup scene during calling/monitoring, to better night view, as below:

DT175/DT433 is not ready for this function yet

### 3. IP Camera quantity automatically configured

With DT-IPG, the quantity of IP Cameras connected will automatically broadcast to monitors, let monitor only display cameras that could be monitoring. Don't need other setup for all monitors.

### 4. Switch IP Camera during calls

Monitor could switch to IP Cameras during calls, calls still going and you could also back to door cameras. To switch to IP Cameras during calls as below:

**DT471:**



*Tap "Camera"*



*Tap "Next Page"*



*Tap "CM-1 to check CM-1"*

**DT437:**



*Press "Down" to switch to camera*

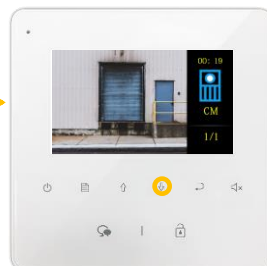

*Press "Down" to switch back to door station*

**DT433**

**DT17S**



*In "installer setup" \*  
nane innut 9101\*\**

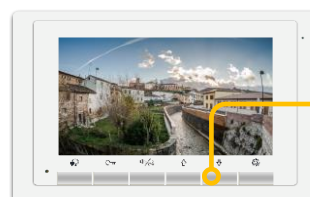

*Press "Down" to switch to Camera*

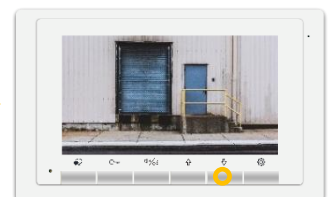

*Press "Down" to switch back to door station*

*\*On DT17S/DT433, "Settings" -> switch to "About" -> Long press "Unlock" to go into "Install setup" page*

*\*\*Set up DS quantity, input code 9101~9104, means 1~4 door stations. 9101 means one door station*

*\*\*\*DT433 and DT17S settings procedure is same.*

**"UP" key during above cases on DT437 DT17S and DT433 could use to open a light which connect on "DT-RLC".**

## 5. SIP Divert and QR code

Now all divert accounts will promote also in QR code, with 2Easy APP is much easier to use, also users could change the password locally on monitor, best choice for apartment project.

### DT471:



✚ If turn on "Do not Disturb" (red arrow) with "Divert" at same time, monitor will divert immediately, if only "Divert" is turn on, monitor will divert if no answer on the monitor.

### DT437:

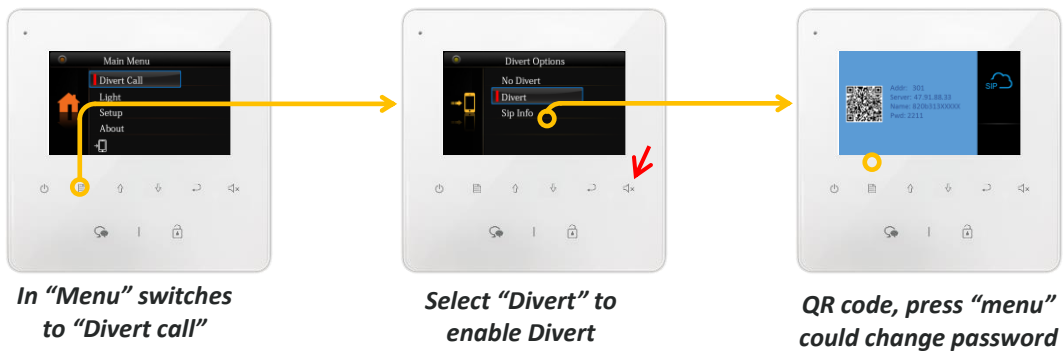

✚ If turn on "Do not Disturb" (red arrow) with "Divert" at same time, monitor will divert immediately, if only "Divert" is turn on, monitor will divert if no answer on the monitor.

### DT433/DT17S(same setting, take DT17S as example):

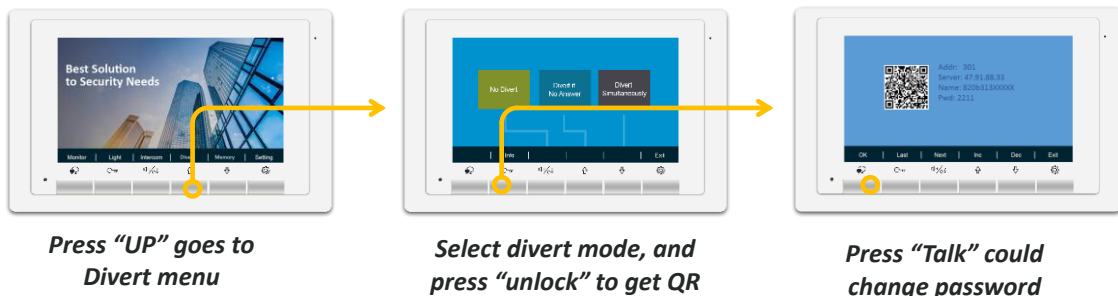



\*DT433 and DT17S settings procedure is same.

## 6. SIP divert optimize

SIP divert now optimize, with different video level, and communicate quality improve. Also as before, if call is diverting will turn in talking state early, now unless the call is pick up on mobile, door station will keep in waiting state.

## 7. Quick check missed calling.

DT-IPG could provide video/picture memory for monitor to each call, more than that, if a call is never been answered, monitor will promote with flash LED to indicator user there is/are missed calls. Also could quickly check with missed calling record as below (in standby):

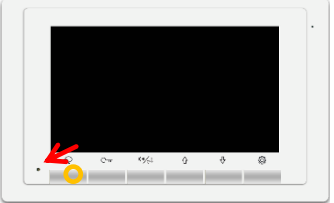
DT471	DT437	DT17S
 <p>When "Power" flash, Press "Talk" to check</p>	 <p>When "Power" flash, Press "Power" to check</p>	 <p>When "Power" flash, Press "Talk" to check</p>

## 8. Remote setup door station from monitor

Monitor could provide a text base menu to setup door station with more delicate settings, such as to set up unlock time, night LED lightness.

Input code "2500" in monitors' "Installer setup" page, and monitor will create a text base menu for user to setup door station remotely, with following password required input "2020", you will see as below:

<b>DS1 Para Settings</b>	
Name: U000 Calling Mode	→ <i>Setting item</i>
Desc: Building/Villa	→ <i>Setting item's description</i>
Value: 0	→ <i>Current setting value</i>
0: Building application	→ <i>Current setting value description</i>
Range: [0,1],[0]	→ <i>Available value and current vale</i>

More than 10 delicate settings which make door station friendlier, also could remotely change password and ID access card.